

ASSEMBLY INSTRUCTIONS:

- 1- FEED WIRES THROUGH REAR BODY AND STRIP WIRE INSULATION TO EXPOSE .060-.090" [1.53-2.28 mm] OF WIRE CORE. INSERT WIRE FULLY INTO CONTACT. CRIMP WIRE TO PIN CONTACT USING FP41735 CRIMP TOOL (CRIMP SETTING 5) WITH FP41731 LOCATOR.
- 2- AFTER CRIMPING SEAT CONTACTS INTO REAR BODY AND INSTALL FRONT BODY OVER EXPOSED CONTACTS.
- 3- SLIP GARTER SPRING IN GROOVE FORMED ON THE TWO BODIES (THIS HOLDS THEM TOGETHER WHEN UNMATED).

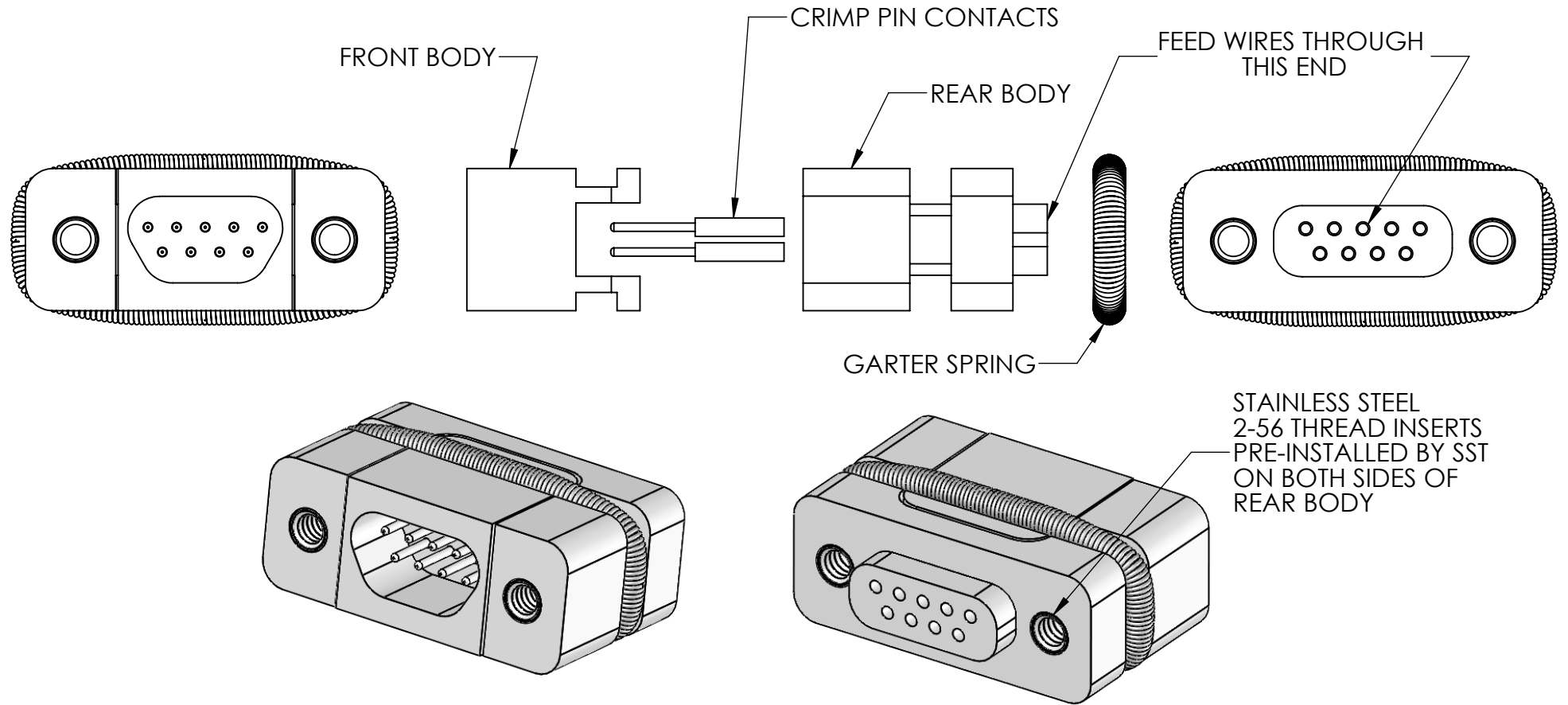

CONTACTS ACCEPT A 28-32 AWG WIRE SIZE FOR CRIMP (MAX INSULATION OD .030" [0.76 mm])

PROPRIETARY AND CONFIDENTIAL THE INFORMATION CONTAINED IN THIS DRAWING IS THE SOLE PROPERTY OF SOLID SEALING TECHNOLOGY. ANY REPRODUCTION IN PART OR AS A WHOLE WITHOUT THE WRITTEN PERMISSION OF SOLID SEALING TECHNOLOGY IS PROHIBITED.				THIRD ANGLE PROJECTION 		TITLE: INSTRUCTION SHEET MICRO D+ IN-VAC RECPT			
REV.	APP'D	DATE	SCALE 3:1	DIMENSIONS IN INCHES [mm]	DRAWN	HJ	04/16/2021	NUMBER:	NS42394
A	JF	04/26/2021	MSMS001-11		ENG APPR.	JF	04/26/2021	REV:	A
								SHEET 1 OF 1	